

# WALL MOUNTED HAND SINKS

MODEL NO.	DESCRIPTION	BOWL SIZE D" X L" X H"	OVERALL SIZES D" X L" X H"	WEIGHT LBS.
HSF-14	Hand Sink with Faucet	10 x 14 x 5	15.25 x 17 x 13.375	15
HS-14	Hand Sink only, 4" Centers	10 x 14 x 5	15.25 x 17 x 13.375	13
HS-14-1	Hand Sink only	10 x 14 x 5	15.25 x 17 x 13.375	13
HS-14SP	Hand Sink with Side Panels	10 x 14 x 5	15.25 x 17 x 13.375	13
HSF-14SP	Hand Sink with Faucet and Side Panels	10 x 14 x 5	15.25 x 17 x 13.5	15
HS-14-1EF	Hand Sink with Electronic Faucet	10 x 14 x 5	15.25 x 17 x 13.375	15
HSF-14BP	Hand Sink with Body Press	10 x 14 x 5	15 x 16 x 21.5	15
HSF-14BP-2	Hand Sink with Body Press - Double	10 x 14 x 5	Per Spec	15

Sizes nominal, detailed specifications available on request. Subject to change without notice

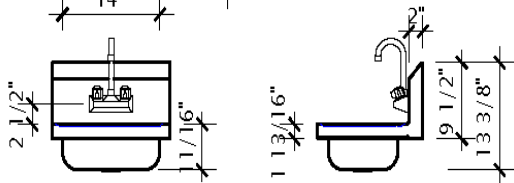
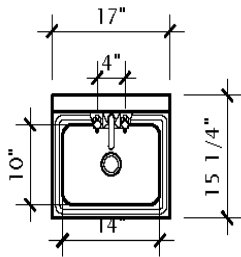

HSF-14 & HSF-14-1EF

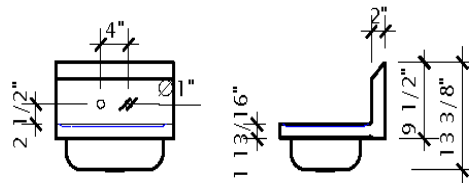

HS-14

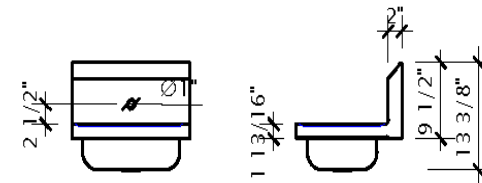

HS-14-1

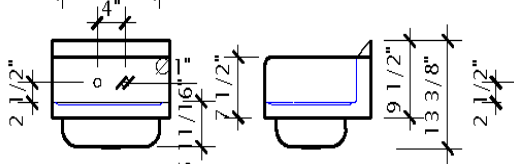
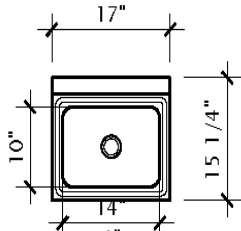

HS-14SP

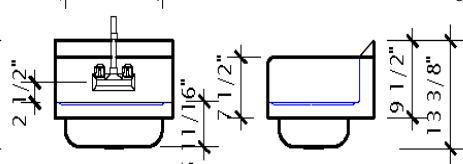
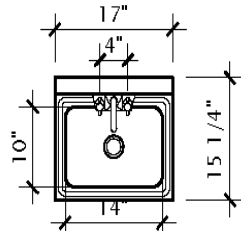

HSF-14SP

Sink base with rounded corners

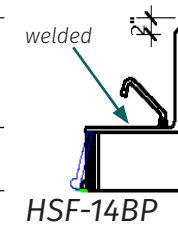
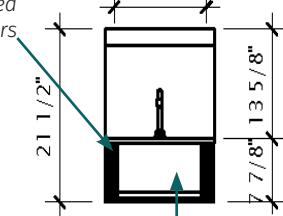
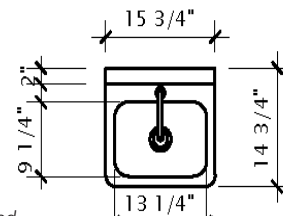

HSF-14BP

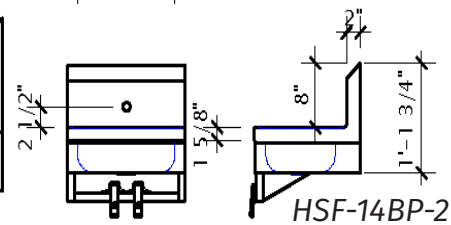
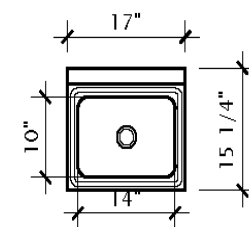

HSF-14BP-2

Body press panel to start water flow

1 1/2" Drain



**CORPORATE HEAD OFFICE**  
 2780 Coventry Road  
 Oakville, Ontario, Canada, L6H 6R1  
 Phone: 905-825-9665  
 Fax: 905-825-0965  
 www.tarrison.com

**US DISTRIBUTION**  
 150 Gratoit Blvd.,  
 Marysville, Michigan, 480240  
 www.tarrison.com

**US SALES OFFICE**  
 4 Park Street  
 Essex Junction, Vermont, 05452  
 Phone: 802-922-7025  
 Fax: 905-825-0965  
 www.tarrison.com